

Pressure Range

From: 0.55 bar g. (7.98 psi g.)
To: 21.00 bar g. (304.50 psi g.)



Temperature Range

-15 °C to 180 °C (subject to seal material)



Flow Area

50.27 mm² (8.00 mm inlet bore diameter)



Connections

Inlet: 1/4" to 1/2" BSP, BSPT, NPT



Seal Materials

Viton®

	ASME	GA 84788
	PED / TÜV / ASME	GA 84188
	PED / TÜV	GA 84888
1	BODY	ST. STEEL 1.4401 (316)
2	SEAL	VITON
3	VALVE DISC	ST. STEEL 1.4401 (316)
4	SPRING	ST. STEEL 1.4310 (302)
5	ADJUSTER	ST. STEEL 1.4401 (316)
6	SPINDLE	ST. STEEL 1.4057 (431)
7	NAMEPLATE	ALUMINIUM ALLOY
8	CAP	ST. STEEL 1.4401 (316)

Notes

- Relieving pressure is set pressure +10% (0.1 bar g. below 1.0 bar g.)
- Reseating pressure is set pressure -10% (0.3 bar g. below 3.0 bar g.)
- Below 3.00 bar g., PED certified only

Approvals

- TÜV Germany (AD-Merkblatt A2)
- BS EN ISO 4126-1
- PED 97/23/EC

DN8

Seetru Limited
Albion Dockside Works
Bristol BS1 6UT
England

Tel: +44 (0) 117 927 9204
Fax: +44 (0) 117 929 8193
sales@seetru.co.uk
www.seetru.co.uk

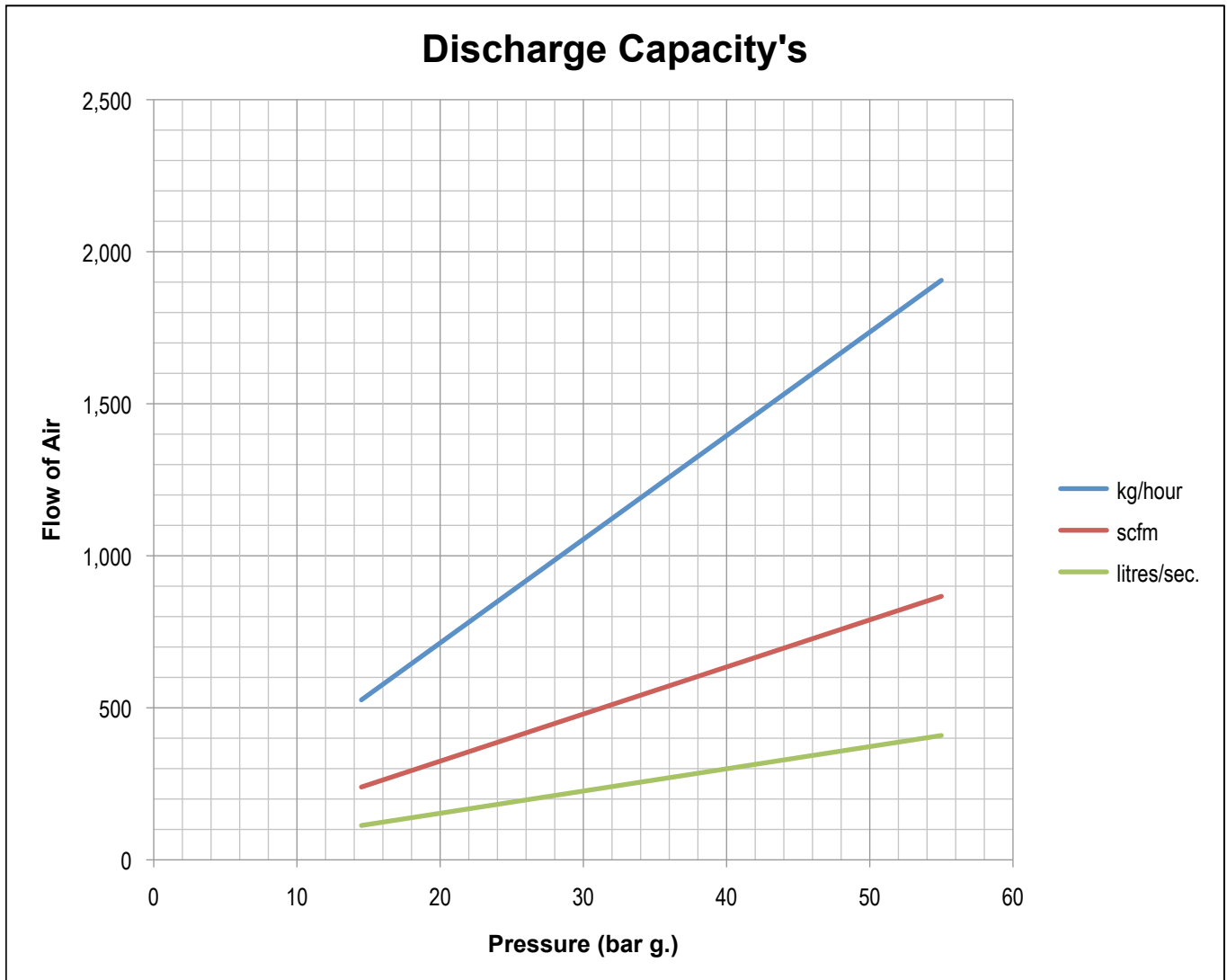

For assistance in sizing a valve to your specifications please contact the Seetru technical sales desk.

Alternate Top Fitting

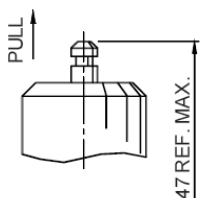

TYPE SL
SPINDLE-LIFT
EASING GEAR

DN8

Seetru Limited
Albion Dockside Works
Bristol BS1 6UT
England

Tel: +44 (0) 117 927 9204
Fax: +44 (0) 117 929 8193
sales@seetru.co.uk
www.seetru.co.uk