

Pressure Range

From: 5.65 bar g. (81.93 psi g.)
To: 21.00 bar g. (304.50 psi g.)



Temperature Range

Up to: 200 °C (subject to seal material)



Flow Area

490.87 mm² (25.00 mm inlet bore diameter)



Connections

Inlet: 1 1/2" BSP, BSPT, NPT
Outlet: 2" BSP



Seal Materials

Nitrile
Viton®
Neoprene
Ethylene Propylene

	LP 67025	LP 68025	LP 69025
1 INLET SEAT	BRASS	ST. STEEL	ST. STEEL
2 SEAL RETAINER	BRASS	ST. STEEL	ST. STEEL
3 'O' RING	TO SUIT	TO SUIT	TO SUIT
4 PLUNGER	BRASS	ST. STEEL	BRASS
5 BODY	BRONZE	ST. STEEL	BRONZE
6 SPRING	ST. STEEL	ST. STEEL	ST. STEEL
7 SPINDLE	ST. STEEL	ST. STEEL	ST. STEEL
8 ADJUSTER	BRASS	ST. STEEL	BRASS
9 CAP	BRASS	ST. STEEL	BRASS
10 NAMEPLATE	ALUMINIUM ALLOY	ALUMINIUM ALLOY	ALUMINIUM ALLOY
11 WIRE & SEAL	ST. STEEL & LEAD	ST. STEEL & LEAD	ST. STEEL & LEAD
12 SCREW	ST. STEEL	ST. STEEL	ST. STEEL

Notes

- Relieving pressure is set pressure +25%
- Reseating pressure is set pressure -20% (0.6 bar g. below 3 bar g.)

Approvals

- TÜV Germany (AD-Merkblatt A2)
- BS EN ISO 4126-1
- PED 97/23/EC

DN25

Seetru Limited
Albion Dockside Works
Bristol BS1 6UT
England

Tel: +44 (0) 117 927 9204
Fax: +44 (0) 117 929 8193
sales@seetru.co.uk
www.seetru.co.uk

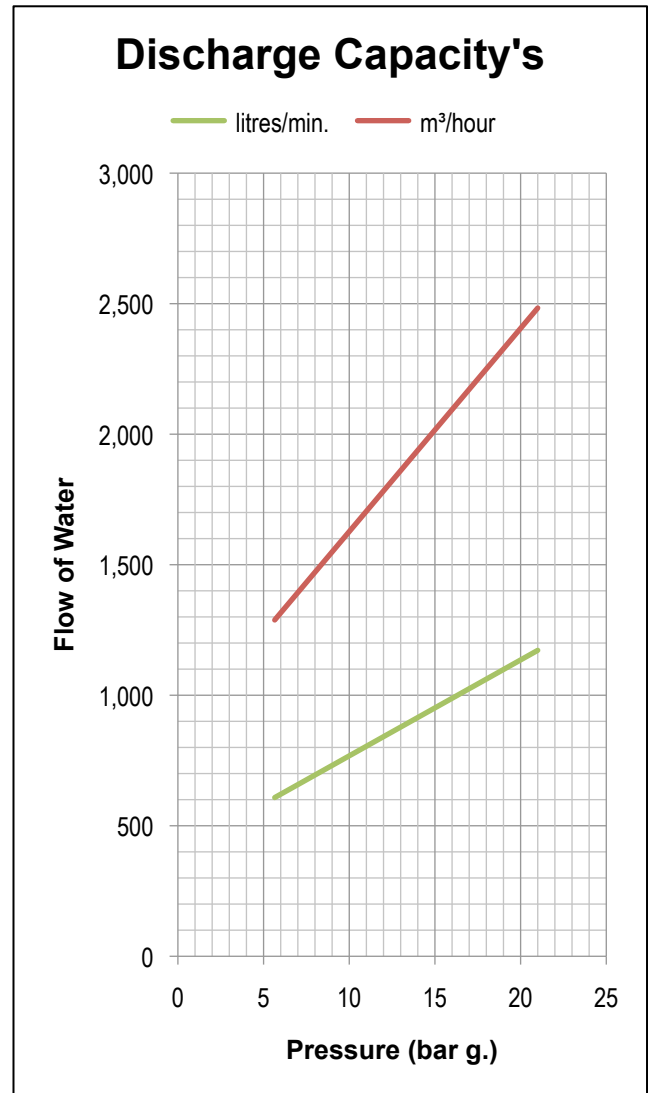
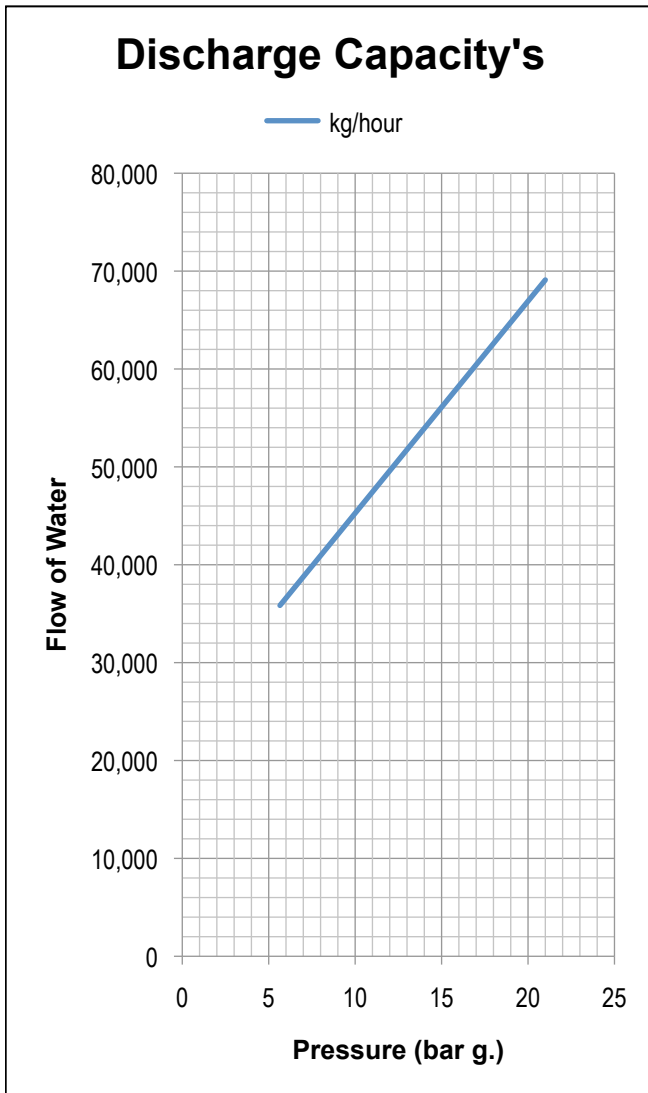

For assistance in sizing a valve to your specifications please contact the Seetru technical sales desk.

Alternate Top Fittings

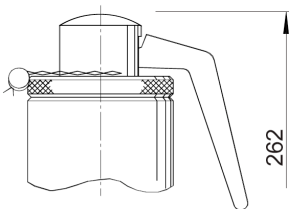

TYPE L
LEVERLIFT
EASING GEAR

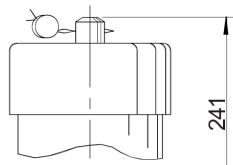

TYPE S
SEALED
NO EASING TYPE

DN25

Seetru Limited
Albion Dockside Works
Bristol BS1 6UT
England

Tel: +44 (0) 117 927 9204
Fax: +44 (0) 117 929 8193
sales@seetru.co.uk
www.seetru.co.uk